



# Round Sight Glass

**Non pressure retaining**  
For welding, similar to DIN 28120

**Type  
317**

## Application:

Observation and illumination of the interior of enclosed vessels (cauldrons, tanks, silos etc.).

Sight glasses consist of round flange mountings to be welded into or onto a vessel, completed by a sight glass plate with appropriate seals.

**Similar to DIN 28120  
Pressureless Operation**

**( $\Delta P \leq 1$  bar)**

## Operating conditions:

Temperature:	150	°C
(depending on glass)	280	°C
Pressure:	0	Bar

## Materials:

Flange:	1.4571 (Base flange) 1.4541 (Cover flange)
Glass:	Borosilicate glass DIN 7080 Soda Lime Glass DIN 8902
Seal:	C4400 PTFE Graphite Or according to Spec.
screws:	A4-70

Other materials on request

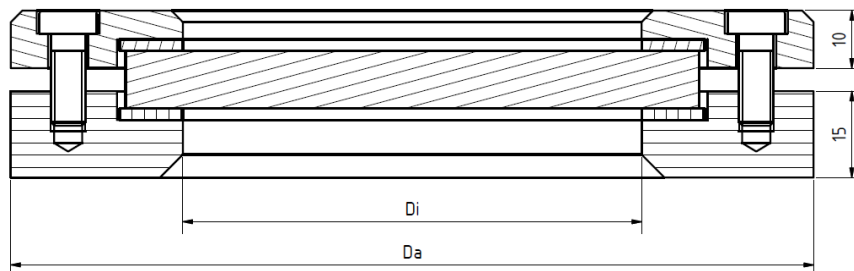

DN	50	80	100	125	150	200
Da	140	165	190	215	240	290
Di	80	100	125	150	175	225
kg	2,5	3,0	3,6	4,5	5,4	8,9
Nm	6	5	6	7	7	8



## Installation guideline:

After welding the base flange onto/into the pressure vessel, the sealing surface must be checked for deformations! Reworking may be required!

The pressure rating does not consider the base flange. This will have to be audited together with the pressure vessel according to AD 2000 instructions B9 or equivalent standard!

Technical changes and errors reserved!

	<h1>Round Sight Glass</h1> <p><b>Non pressure retaining</b> For welding, similar to DIN 28120</p>	<h1>Type 317</h1>
---	---	-----------------------

Product Code:

		DN	Flange	Glass	Seal	Variants
11	317	Acc. To table	1: 1.4571	1: BS transparent 2: SL Transparent 3: Quartz 4: BS + PTFE Wiper 5: BS + Sil. Wiper	1: PTFE 2: FKM 3: NBR 4: C4400 5: Silicone 6: EPDM 7: Graphite 8: Special	Assigned by ACI as required

## Options

To mount lights, cover flanges can be equipped with appropriate threaded bores.

Installation of a wiper type SW I is also possible.

Example:	<b>ACI Type 317</b> DN100 Flange 1.4571 / 1.4541 Borosilicate glass Seal PTFE Standard construction	11-317-100-1-1-1-000
----------	--	----------------------

**Recommendation:**  
 For aggressive media or steam, we recommend adding a mica disk to protect the glass!

Technical changes and errors reserved!