



Four Way Sight Glass

With Flanged Connections

**Type
595**

Application:

Visual Checking of Filling and Flows in Piping.
Sight Glasses allow for reliable Observation of
Function and Performance in single devices or
complete plants.

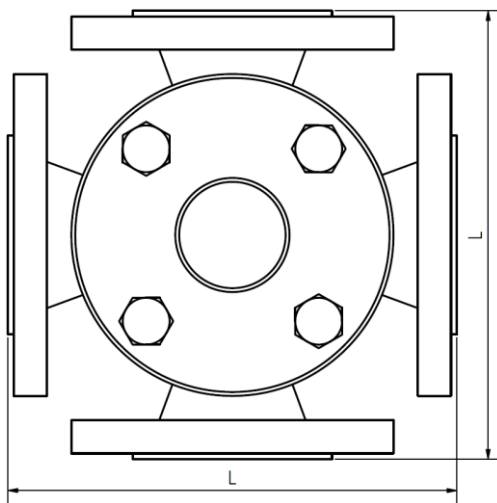
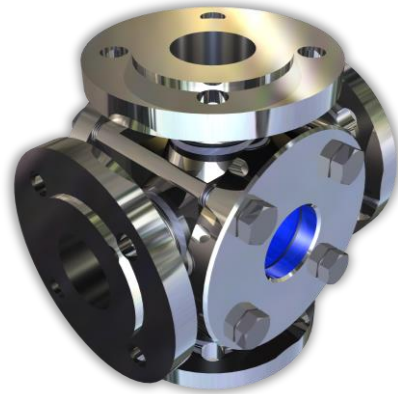

Materials:

Body | 1.4571
| 1.4404
| Steel

Glass: | Borosilicate glass DIN 7080
| Soda Lime Glass DIN 8902
| Quartz GLass
| META®-Glass

Seal: | Graphite MST or as chosen

Other materials on request

Operating conditions:

Pressure: | PN16
| PN40

Temperature: | 150°C (DIN 8902)
| 280°C (DIN 7080)

DN	15	20	25	40	50	65	80	100
L	200	230	310	350	400	480	600	730

Other sizes on request

High Pressure Version:
Available on request.

Recommendation:
For corrosive media or steam, mica disks should be used.

Technical changes and errors reserved!

